

1 2 3 4 5 6 7 8

REV	LOCATIONS	DESCRIPTION	DATE	REVISER	APPD

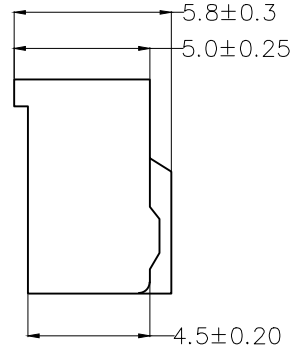
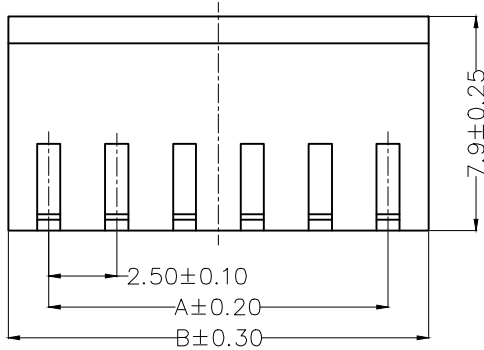
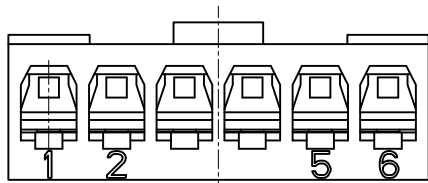

SPECIFICATIONS

Electrical  
 Temperature Range—Operating: -25°C~+85°C  
 Material and Plating  
 Housing: PA66 (UL 94V-0)  
 Applicable Terminal: FT25020  
 Mates With (Wafer): FWF25014,FWF25032 Series

Ordering Information

FHG 250 20 — S XX M 2 BN B  
 1 2 3 4 5 6 7 8 9

1	Category FHG—Housing	2	Series Number 250—Pitch2.50mm	3	Distinction No. 20	4	Row Option S—Single Row		
5	Circuits XX	6	Type M—Male	7	Material—Resin 2—PA66	8	Color—Resin BN—Brown	9	Packaging B—PE Bag

Circuits (n)	Part No.	Dimensions	
		A	B
2	FHG25020—S02M2BNB	2.50	5.50
3	FHG25020—S03M2BNB	5.00	8.00
4	FHG25020—S04M2BNB	7.50	10.50
5	FHG25020—S05M2BNB	10.00	13.00
6	FHG25020—S06M2BNB	12.50	15.50
7	FHG25020—S07M2BNB	15.00	18.00
8	FHG25020—S08M2BNB	17.50	20.50
9	FHG25020—S09M2BNB	20.00	23.00
10	FHG25020—S10M2BNB	22.50	25.50

<p>THIRD ANGLE PROJECTION</p>	GENERAL TOLERANCES (UNLESS SPECIFIED)		APPROVE BY LEO	DATE 01/JUL/13	PART NO. FHG25020—SXXM2BNB	ITEM NO. FHG25020	<p>Building Technology Cornerstone</p>	
	X. ±0.30	X.* ±5°	CHECKED BY GISELLE	DATE 01/JUL/13	TITLE Wire to Board Pitch 2.50mm(Housing)			REV 0
	DESIGN UNITS METRIC(mm)	X.X ±0.20	X.X* ±2°	DRAWN BY MATT	DATE 01/JUL/13	THIS DRAWING CONTAINS INFORMATION THAT IS PROPRIETARY TO TXGA INDUSTRIAL ELECTRONICS(S.Z)CO.,LTD AND SHOULD NOT BE USED WITHOUT WRITTEN PERMISSION		
	SCALE 5:1	SIZE A4	X.XX ±0.15	X.XX* ±1°	X.XXX ±0.10	X.XXX* ±0.5°		

1 2 3 4 5 6 7 8